

Series DED

Sub-miniature strip,
Linked



FEATURES & SPECIFICATIONS

INTENDED USE

Sub-miniature strip to illuminate tight spaces. Ideal for display and shelf lighting. Fixtures may be used individually, or linked, end to end, without cords.

SIZE W x L x H in inches (mm)

0.9W x 1.7H (23 x 43) - dimensions include lamp and lens
Fixture length shown below: ordering chart, lamp type

MATERIALS & FEATURES

Metal construction with acrylic diffuser. Each double insulated fixture is provided with a two prong cord and mounting hardware. Fixtures may be linked (plugged directly, one into another) without a cord for continuous rows. Six inch accessory cord is also available for continuous power around corners.

- Sub-miniature housing for tight spaces
- Fixtures link, without cords, for continuous row mounting
- Cord, mounting hardware, lamp shipped as a single piece.

MOUNTING

Surface mount brackets, included.

LISTING

Fixture: UL Listed.

TYPICAL OPTIONS AND ACCESSORIES

Accessory cord, white, 6 inch, to provide continuous power when fixtures are not directly linked. Order as a separate line item: DED/6-Join.

ORDERING INFORMATION

Example: **DED 13 LN41**

DED	13	LN41
Series	Lamp Type (Lamps Included)	Lamp Color
DED Sub-miniature strip, Linked	08 13 14 21 28	LN41 8W Installed, 4100K, Fixture length = 13.5 in. LN41 13W Installed, 4100K, Fixture length = 22.5 in. LN41 14W Installed, 4100K, Fixture length = 23.7 in. LN41 21W Installed, 4100K, Fixture length = 21.0 in. LN41 28W Installed, 4100K, Fixture length = 47.4 in.

Two prong power cord, lamp, and mounting hardware included with each fixture.

Accessory



DED/6-JOIN

6 in. cord to join fixture to fixture

Series DED

Sub-miniature strip,
Linked



DIMENSIONS

All dimensions are inches. Specifications subject to change without notice.

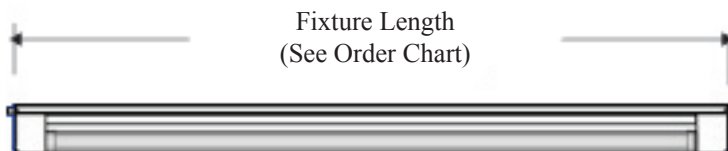
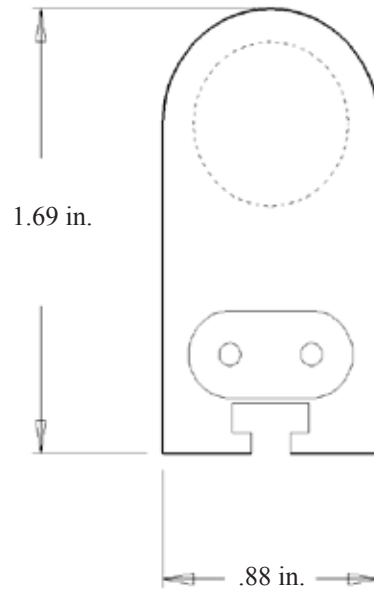

Fixture Length
(See Order Chart)

Catalog Number:
Notes: