

VAN Series

Wall Mount End Cap Bath Bars

Application

The end cap bath bar series of diffuser assemblies allow the lighting designer and manufacturer to produce a cost effective, yet elegantly styled luminaire.

Attributes

By utilizing our spring clips with a standard strip fixture, a low cost luminaire with a high perceived value can be achieved.

Diffuser

The diffuser assembly consists of a solid white, clear fluted, or white fluted profile mated to a choice of end cap sizes and colors. We have expanded the range of offerings on the End Cap Bar series to include a new Frosted Ribbed Diffuser. The new diffusers give the appearance of frosted glass, while maintaining the shipping and usage durability of acrylic. The diffuser is available with full range of standard caps, narrow caps, inclusive of all marble colors and trim options. The following information is used to specify the Frosted Ribbed Diffuser.

Mounting

The spring clips, when fastened to the strip fixture, creates a pressure fit mounting method, allowing the completed luminaire to be suitable for either vertical or horizontal wall mounts.



MADE IN AMERICA



Options

A range of colors are available from basic opaque white to a family of marble effects. We have developed colors which can emulate effects of translucent alabaster or marble grains, or a variety of opaque faux marble finishes. We can also develop a custom end cap color, shape, or custom profile for proprietary applications if requested by the manufacturer.

DIMENSIONS

Standard End Cap (1 1/2" wide) - EC

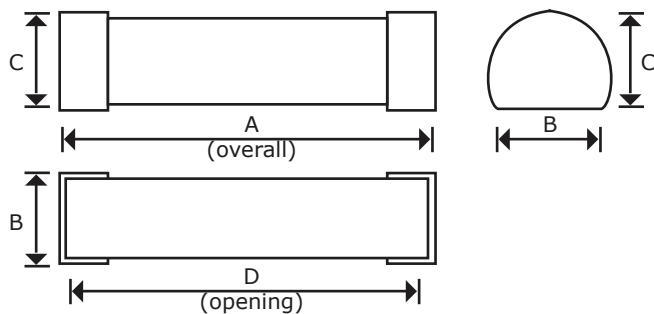

Series	A	B	C	D
VAN 24L	25 1/2	4 3/4	4	24 1/8
VAN 36L	37 1/2	4 3/4	4	36 1/8
VAN 48L	49 1/2	4 3/4	4	48 1/8

Narrow End Cap (1/2" wide) - ECN

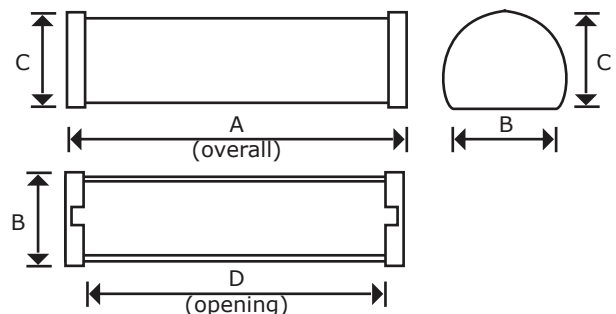

Series	A	B	C	D
VANW 24L	25 1/2	4 3/4	4	25
VANW 36L	37 1/2	4 3/4	4	37
VANW 48L	49 1/2	4 3/4	4	49

DIMENSIONS

All dimensions are inches. Specifications subject to change without notice.

*Consult for more options

Catalog Number:
Notes:

